



Multi-Purpose Therapy Stand

Operation and Maintenance Manual

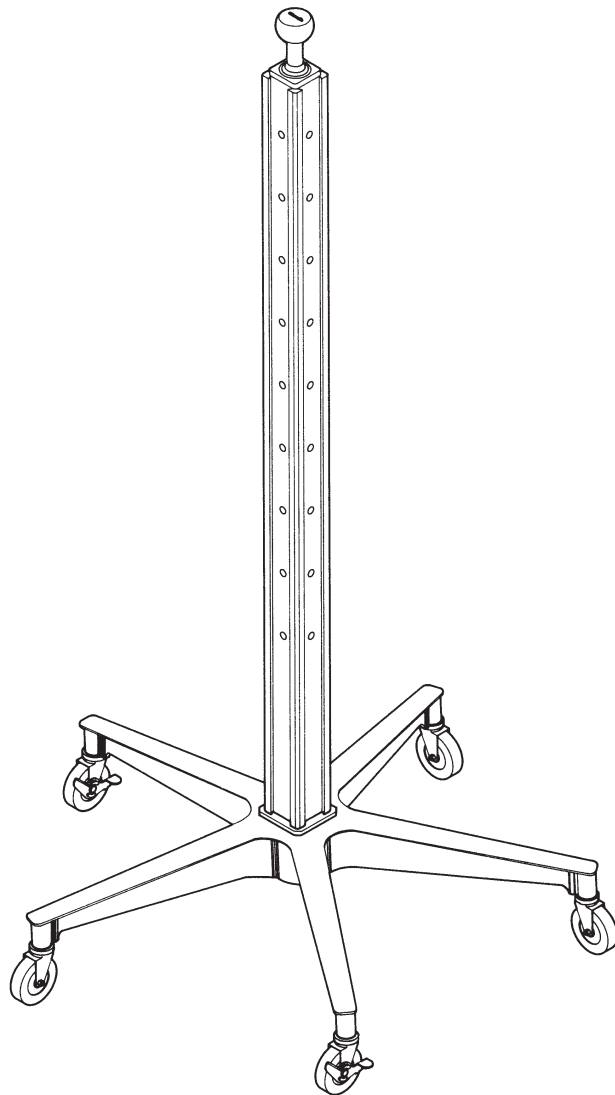

Table of Contents

1/Description	3
1.1 General	3
1.2 Specifications	3
1.3 Accessories	4
2/Set-Up.....	6
3/Checkout Procedure	7
4/Operation.....	7
5/Maintenance.....	8
5.1 Repair Policy and Procedure	8
5.2 Cleaning and Disinfection	8
6/Illustrated Parts	9
Warranty	11

User Responsibility

This Product will perform as described in this operating manual and accompanying labels and/or inserts, when assembled, operated, maintained and repaired in accordance with the instructions provided. This Product must be checked periodically. A defective product should not be used. Parts that are broken, missing, worn, distorted or contaminated should be replaced immediately. Should such repair or replacement become necessary, see the Ohio Medical service manual for service or repairs to this product. For service advice, Ohio Medical recommends that a telephone request be made to the nearest Ohio Medical Regional Service Center.

This Product or any of its parts should not be repaired other than in accordance with written instructions provided by Ohio Medical and by Ohio Medical trained personnel. The Product must not be altered without the prior written approval of Ohio Medical's Quality Assurance Department. The user of this Product shall have the sole responsibility for any malfunction which results from improper use, faulty maintenance, improper repair, damage, or alteration by anyone other than Ohio Medical.

Precautions

Warnings

To maximize stability when the stand is moved, ensure that the load is evenly distributed. Heavy items should be placed near the base if possible.

Do not wheel the stand over tubing that is connected to the patient or equipment.

Ensure that there is enough slack in the connecting tubing to allow for required movement. DO NOT wheel the stand over tubing that is connected to the patient or equipment.

Cautions

Latch the locking casters securely when the stand is used in a stationary position.

Ensure that the slide bracket and regulator supports are locked into the selected position holes before attaching accessories.

Many cleaning and sterilization liquids have adverse effects on plastic parts. Use caution in the selection of these agents.

1/Description

1.1 General

The Multi-Purpose Therapy Stand provides maximum stability and supports a variety of vacuum, oxygen, and other therapy accessories.

The upright stand incorporates the Ohio Medical rail system for ease of mounting accessories on all four sides. The upright rail has recessed holes at equal intervals on all four sides. This feature allows the user to mount the accessories at the desired levels. The top of the upright has a convenient handle for moving the stand.

The base has five casters for ease of movement and stability. Two of the five casters may be locked to hold the stand in place.

The stand can handle an array of equipment, for example, eight Ohio Medical 1/2 gallon or 1 gallon collection bottles, a vacuum regulator with safety trap, an instrument tray, tubing, and hoses required for operation.

1.2 Specifications

Weight:	10 lbs. 10 oz (4.82 kg) (stand only)
Shipping weight:	16 lbs. 12 oz (7.6 kg) (stand only)
Height:	43 3/4" (111 cm) (assembled)
Rail Length:	35" (89 cm)
Base Diameter:	24" (61 cm)
Caster Diameter:	2" (5 cm)
Maximum Load Limit:	50 lbs. (22.7 kg) (equally distributed)

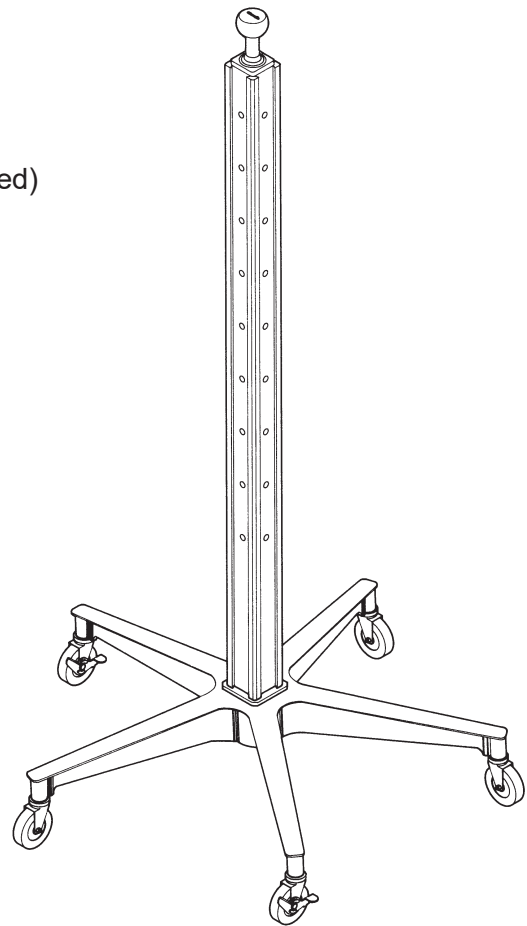

1/Description

1.3 Accessories

Table 1 - Multi-Purpose Therapy Stand Assemblies and Accessories

Multi-Purpose Therapy Stand Assembly	Slide Bracket	Reg. Support	Retaining Clip	Surgical Reg. (Free-Flow)	Continuous Reg.	Instrument Shelf
North American	6700-0014-800	6700-0016-800	0217-5276-100	6700-0100-900	6700-0106-900	0217-5365-800
6700-0001-900	2	1	2			
6700-0002-900	2	1	2	1		
6700-0003-900	4	1	4			
6700-0004-900	4	1	4	1		
6700-0005-900	0	1	4	1		1
6700-0107-900	4	1	4		1	
International	6700-0015-800	6700-0016-800	0217-5276-100			
6700-0006-900	2	1	2			
6700-0008-900	4	1	4			

Multi-Purpose Therapy Stand less accessories 6700-0025-800

Vacuum Slide Brackets:

Mounts on any side of the vertical rail and accepts vacuum trap bottles or similarly attached items.

North American Slide (straight) 6700-0014-800 International "V" Slide 6700-0015-800



Vacuum Regulator Support:

Mounts on any side of the vertical rail. For use with the Continuous, Surgical/Free-Flow, and Intermittent Vacuum Regulators.

6700-0016-800

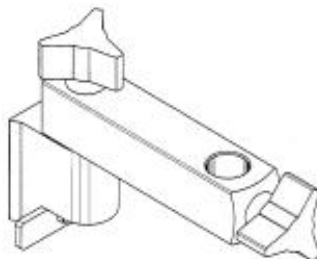

Instrument Shelf:

A 12"x12" (30.48cm x 30.48cm) swivel shelf that can be mounted anywhere on the rail system. Max load 20 lbs/9kg.

217-5365-800



Retaining Clips:

Snap-in horseshoe-shaped plastic clips fit into rail bevels and can be positioned anywhere to guide and organize power cords, monitoring leads, fluid lines or breathing hoses.

Pack of 6. 217-5290-870



1/Description

Air and O₂ Flowmeters w/Bracket:

Flowmeter and manifold block mount to the rail. A DISS (Diameter Index Safety System) inlet is provided for connection to a gas supply. A DISS checked outlet is provided for gas supply to other needs.

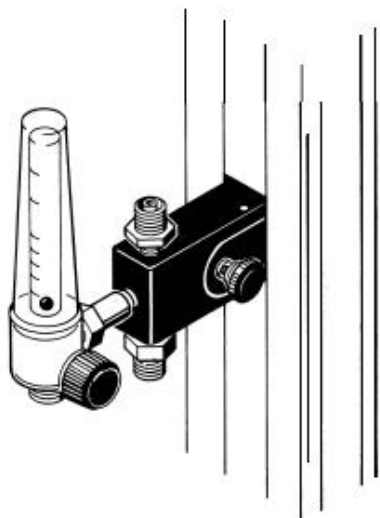

O₂ Flowmeters w/Bracket

USA
International English
French
Spanish
Canada

Air Flowmeters w/Bracket:

USA
International English
French
Spanish
Canada

Vacuum Manifold Bracket:

Includes two DISS Vacuum adapters and allows for adaptation of vacuum regulators.

217-5369-800

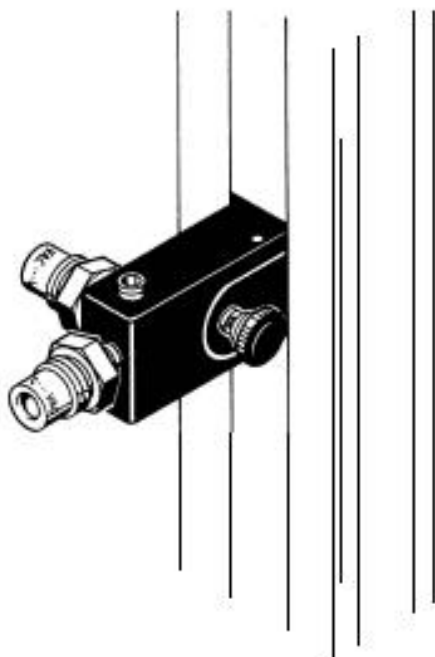

Universal Manifold Bracket:

Incorporates four NPT (National Pipe Thread) ports for custom adaptation, with one port open and three plugged with 1/8" NPT pipe plugs.

217-5359-800



2/Setup

After removing the Multi-Purpose Therapy Stand from the packaging, inspect the stand and all accessory items for damage that may have occurred during shipment. If damage is found, DO NOT USE and file a damage claim with the shipping carrier. Also confirm the presence of all accessory items listed on the packing slip.

Note: To assemble the Multi-Purpose Therapy Stand, an adjustable wrench or spanner is required.

1. Remove the rail and base with casters from the shipping carton.
2. Loosen and remove the nut, washer and cardboard tube from the end of the threaded rod. Discard the cardboard tube leaving the threaded rod inside the rail. The handle should remain inserted in the other end of the rail.
3. With the threaded rod still inside the rail and the plastic spacer in position at the base of the rail, place the threaded rod through the center hole of the base. Make sure that the plastic spacer is positioned flat on the base.
4. Attach the rail assembly to the base. While holding the rail on the base, place the washer on the rod, and secure with the mounting nut. Use a wrench to carefully tighten the mounting nut.
5. Attach the vacuum slide brackets and regulator support by sliding them down from the top of the rail. Lift the adjustment tab at the bottom of the mounting bracket to relocate accessories.

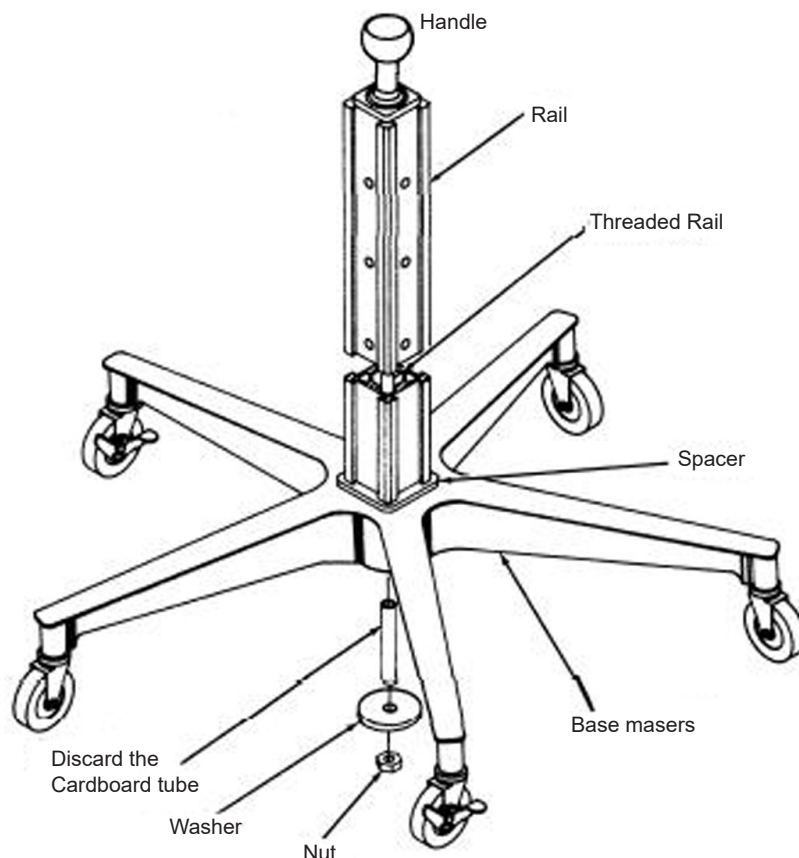

Figure 2
Multi-Purpose Therapy Stand Assembly

3/Checkout Procedure

1. Check the overall integrity of the Multi-Purpose Stand. Parts that are broken, missing, worn, or distorted should be repaired or replaced.
2. Check the condition of the five casters on the stand. Make sure the stand rolls easily.
3. Check that the two locking casters hold the stand in place when in the locked position.
4. Check that the mounting nut that holds the upright to the stand is tight.
5. Check that the rail channels accept accessories and that they lock into all position holes on all four sides.

4/Operation

WARNING: To maximize stability when the stand is moved, ensure that the load is evenly distributed. Heavy items should be placed near the base if possible.

WARNING: Ensure that there is enough slack in the connecting tubing to allow for required movement. Do not wheel the stand over tubing that is connected to the patient or equipment.

CAUTION: Latch the locking casters securely when the stand is used in a stationary position.

CAUTION: Ensure that the slide bracket and regulator supports are locked into the selected position holes before attaching accessories.

1. Perform the checkout procedure before using the stand with a patient.
2. Attach the required accessory items to the stand. See Figure 3.
3. When the stand is used in a stationary position, lock the two locking casters. To lock a caster simply push down on the raised lever arm on the unlocked caster. There are two locking casters on the stand. To release a caster push down on the raised lever arm on the locked caster.

Note: To attach a vacuum regulator to the Vacuum Regulator Support, part numbers 0213-5025-300 and 0204-7905-535 are required, as shown.

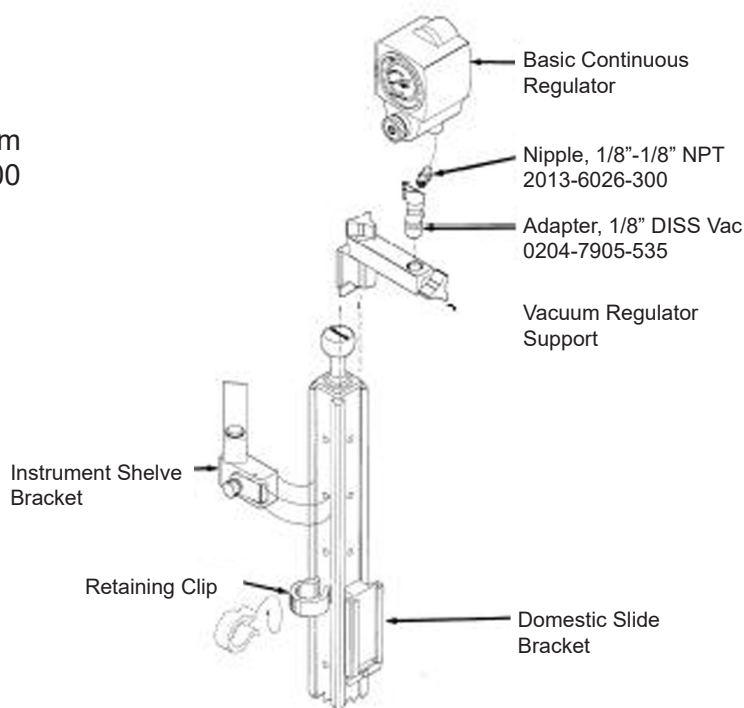

Figure 3
Attachment Methods for Various Accessories

5/Maintenance

5.1 Repair Policy and Procedure

Warranty repair and service must be performed by Ohio Medical at the address listed below.

NEVER use malfunctioning equipment. Make all necessary repairs or have the equipment repaired by an Ohio Medical Service Representative. Parts listed in the service manual, for this product, may be repaired or replaced by a competent, trained person who has experience in repairing devices of this nature. After repair, perform the checkout procedure to ensure that it is functioning properly.

WARNING: To reduce transportation personnel and/or service personnel exposure to hazardous contamination, clean and disinfect before shipping for service.

CAUTION: Only competent individuals trained in the repair of this equipment should attempt to service it.

Contact Ohio Medical Technical Support listed on the back cover, for assistance.

Whether you send the unit for warranty service or non-warranty service, package it securely for protection, and ship it prepaid. Enclose the following five items:

1. A letter describing in detail any difficulties experienced with the unit.
2. Warranty information - (when less than 1 year old) a copy of the invoice or other applicable documentation must be included.
3. Purchase order number to cover repair of a unit not under warranty.
4. Return address and billing address information.
5. Person (name and telephone number) to contact for functional questions.
6. Call toll free 866-645-6446 or 847-855-0500 and ask customer service for an RMA number to include with your shipment.

Ohio Medical, LLC
1111 Lakeside Drive
Gurnee, IL 60031
RMA# _____

Non-warranty repairs will be made at Ohio Medical's current list price for replacement part(s) plus a reasonable labor charge.

5.2 Cleaning and Disinfection

CAUTION: Many cleaning and sterilization liquids have adverse effects on plastic parts, use caution in the selection of these agents.

The stand surfaces can be cleaned with detergents or liquid disinfecting agents which are safe for use on these surfaces. Keep the conductive rubber casters free of dust, dirt and wax.

Clean contaminated regulators in accordance with the Operation and Maintenance Manual for that product. Refer to the Suction Bottle Assembly Operation and Maintenance Manual for proper cleaning and sterilization of the suction bottles.

WARNING: After patient use, the stand may be contaminated. Handle in accordance with your hospital's infection control policy.

6/Illustrated Parts

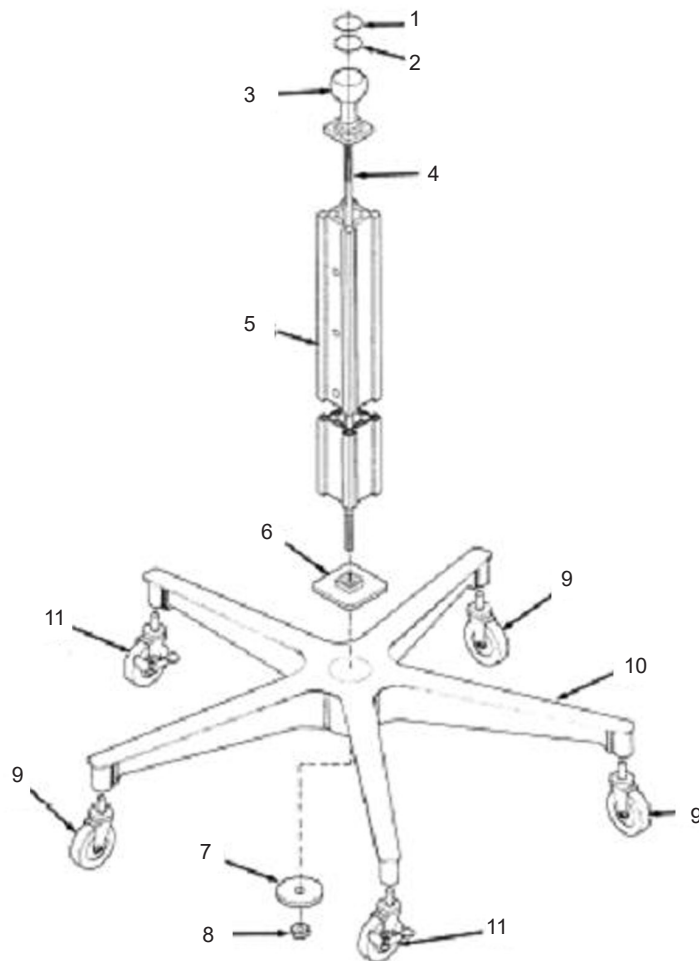

Item	Description	Stock Number
1	Label	
2	Disc	6700-0046-700
3	Handle	
4	Threaded Rod	6700-0009-400
5	Upright	6700-0013-500
6	Spacer	6700-0006-500
7	Washer	6700-0012-400
8	Nut, 5/16-18	6700-0025-400
9	Caster, without lock	0415-8101-300
10	Base	6700-0021-400
11	Caster, with lock	6700-0022-400

Figure 4
Multi-Purpose Therapy Stand

6/Illustrated Parts

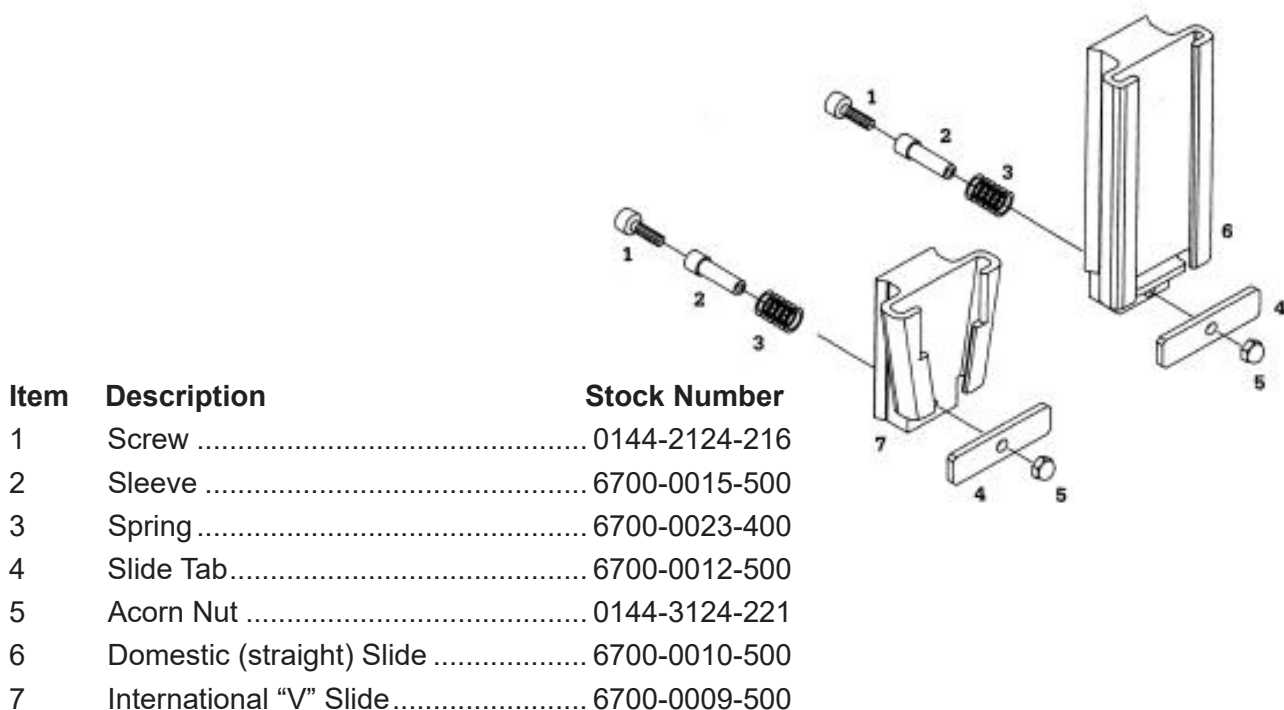

Figure 5
North American and International Slide Brackets

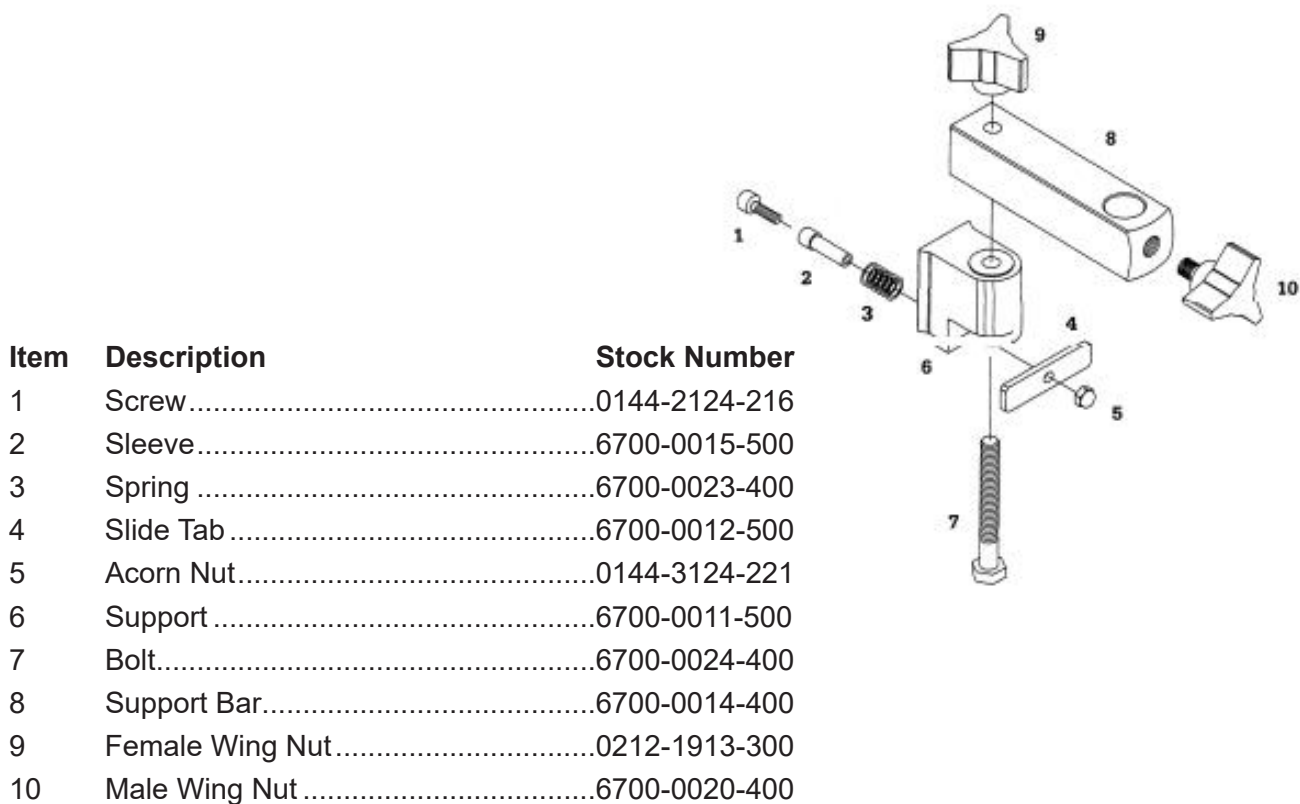

Figure 6
Vacuum Regulator Support Bracket

Warranty

This Product is sold by Ohio Medical, LLC (the “Company”) under the express terms of the warranty set forth below.

For a period of 1 year (12) MONTHS from the date the Company ships this Product to the customer, but in no event for a period of more than one years from the date of original delivery by the Company to an authorized dealer, this Product, other than its expendable parts is warranted to be free from functional defects in materials and workmanship and to conform in all material respects to the description for the Product contained in this operation manual, if this Product is properly operated under conditions of normal use, regular periodic maintenance and service is performed and repairs are made in accordance with this operation manual. The warranty period for all expendable parts of the Product is sixty (60) days from the date the Company ships the Product to the customer.

The Company’s sole and exclusive obligation and customer’s sole and exclusive remedy under the above warranty is limited to repair or replacement, at the Company’s option, of the defective Product.

The foregoing warranty shall not apply if the Product has been repaired or altered by anyone other than the Company or an authorized dealer; or if the Product has been subjected to abuse, misuse, negligence, or accident.

The Company reserves the right to stop manufacturing any product or change materials, designs, or specifications without notice.

This warranty is extended to only the initial customer with respect to the purchase of this Product directly from the Company or an authorized dealer as new merchandise. Dealers are not authorized to alter or amend the warranty of any Product described in this agreement. Any statements, whether written or oral, will not be honored or be made part of the agreement of sale.

THIS WARRANTY IS EXPRESSLY IN LIEU OF ANY OTHER WARRANTIES, EXPRESS OR IMPLIED, INCLUDING ANY WARRANTY OF MERCHANTABILITY OR FITNESS FOR A PARTICULAR PURPOSE. THE COMPANY SHALL NOT BE LIABLE FOR INCIDENTAL, COLLATERAL, CONSEQUENTIAL, OR SPECIAL DAMAGES INCLUDING, BUT NOT LIMITED TO, LOST PROFITS, OR LOSS OF USE. THE COMPANY’S LIABILITY, IN THE AGGREGATE, SHALL NOT EXCEED THE PURCHASE PRICE OF THE PRODUCT.

In order to file a warranty claim, customer is required to return Product prepaid to the Company at 1111 Lakeside Drive, Gurnee IL, 60031 USA. As determined at the sole discretion of the Company, Products which qualify under the warranty will be repaired or replaced, at the Company’s option, and returned to customer via ground delivery at the Company’s expense.

All claims for warranty must first be approved by Ohio Medical, LLC Customer Service Department. For US Domestic customer returns: customer.service@ohiomedical.com or 1-800-662-5822 (Option 3). For International customer returns: intl.customerservice@ohiomedical.com or 1-800-662-5822 (Option 3). Upon approval the customer service department will issue a Return Goods Authorization (RGA) number. An RGA must be obtained prior to commencement of any warranty claim.



**North America
United States**

**Customer Service, Distribution Center
Technical Support, Sales and Service
Equipment Service Center**



Ohio Medical LLC
1111 Lakeside Drive
Gurnee, IL 60031 USA
+1 (866) 549 6446



EMERGO EUROPE
Prinsessegracht 20 2514 AP
The Hague The Netherlands

**AUSTRALIAN SPONSOR:
EMERGO AUSTRALIA**
Level 20, Tower II Darling Park 201 Sussex
Street Sydney, NSW 2000 Australia

© 2019 Ohio Medical, LLC.

This document contains information that is proprietary and confidential to Ohio Medical, LLC. Use of this information is under license from Ohio Medical, LLC. Any use other than that authorized by Ohio Medical, LLC is prohibited.

Ohio Medical and the Ohio Medical Logo are registered trademarks of Ohio Medical, LLC.