

DrägerService®

Dräger

Field Service Procedure

Part Number: SP00260

Rev: -

Date: 14 February 2003

© 2003 Draeger Medical, Inc.

Kit, APC Power Supply Replacement on Narkomed Models 4, 3, 2C, 2B, and GS

[RETURN TO SERVICE PROCEDURE TABLE OF CONTENTS](#)
[RETURN TO CD-ROM TABLE OF CONTENTS](#)

Kit - APC Power Supply Replacement on Narkomed Models 4, 3, 2C, 2B, and GS

Introduction

This procedure includes instructions for the replacement of the Saturn WPU power supply (UPS) as related to Narkomed model numbers 4, 3, 2C, 2B, and GS. The APC Power Supply Kit numbers will vary depending on the model number of the Narkomed Machine. Kit number 4117870-001 is to be used on the Narkomed 4, 3, and 2C. Kit number 4117870-001 consists of the following parts:

- | | |
|-------------------------------------------|-------------------------------------|
| -- Power Supply Assembly, APC P/N 4117859 | -- Base, Power Supply P/N 4117869 |
| -- Transformer, P/N 4114985 | -- Screw, Button Head P/N HW09005 |
| -- Washer, Lock P/N HW67006 | -- Power Cord Asm, 6 FT P/N 4110334 |
| -- Label, P/N 4112866-055 | -- Power Cord Asm, 3 FT P/N 4110333 |

Kit number 4117870-002 is to be used on the Narkomed 2B and GS. Kit number 4117870-002 consists of the following parts:

- | | |
|-------------------------------------------|-------------------------------------|
| -- Power Supply Assembly, APC P/N 4117859 | -- Base, Power Supply P/N 4117869 |
| -- Transformer, P/N 4114985 | -- Screw, Button Head P/N HW09005 |
| -- Power Supply Bracket P/N 4115957 | -- Washer, Lock P/N HW67006 |
| -- Label, P/N 4112866-056 | -- Power Cord Asm, 3 FT P/N 4110333 |
| -- Power Cord Asm, 6 FT P/N 4110334 | -- Screw, Button Head P/N HW09013 |
| -- Washer, Lock P/N HW67006 | -- Nut, Kep P/N HW55002 |

NOTE: Ensure the appropriate kit had been obtained prior to beginning the installation procedures.

The following procedures are divided into two sections. Each section contains detailed instruction based on the appropriate kit number and Narkomed model number being modified. Proceed to the appropriate section.

Replacement Procedure

KIT NUMBER 4117870-001 - NARKOMED 4, 3, AND 2C

1. Turn the system power switch to STANDBY.
2. Disconnect AC power from the machine and pull all circuit breakers to their 'out' position.
3. Remove the bottom and middle drawers from the machine by sliding them off of the cabinet rails.
4. Disconnect power supply cables from the Saturn processor. Disconnection of these cables will depend on the processor installed on the machine. Figures 1, 2, and 3 illustrate the cable connections for each of the three processor configurations.
5. Unscrew the four captive screws attaching the Saturn power supply to the machine power supply. Figure 4 illustrates the current Saturn power supply mounting configuration. Discard old power supply and hardware.

NOTE: The Saturn power supply assembly is assembled and shipped from the factory as a unit. This assembly will contain the power supply, the transformer, and the label already mounted on the power supply base.

6. Place the new Saturn power supply assembly flush on top of the Narkomed power supply.
7. Align the Saturn power supply assembly mounting holes with existing holes on the top portion of the Narkomed power supply.
8. Using a standard allen wrench, attach the new Saturn power supply assembly using four button head screws and four lock washers. Ensure that A/C outlets are facing the left side of the machine. See Figure 5.

NOTE: Narkomed 4 model machines will require that cables be routed through corner notch between power supply assembly base plate and machine frame rails.

9. Reconnect new power supply cables from power supply to processor unit. See Figures 1, 2, and 3 for correct cable connections based on the processor installed.
10. Reinstall bottom and middle drawers into machine.
11. Reconnect AC power to the machine and press circuit breakers into their 'in' position.
12. Turn the system power switch to 'ON'.
13. Verify system power up is successful.
14. If system fails to power up, perform the following:

Replacement Procedure

- Ensure circuit breakers are 'in'.
- Ensure AC power is applied to the machine.
- Ensure system power switch is in the 'on' position.
- Ensure cable connections are correct.

15. If system continues to fail power up, contact your DMIT technical service representative.

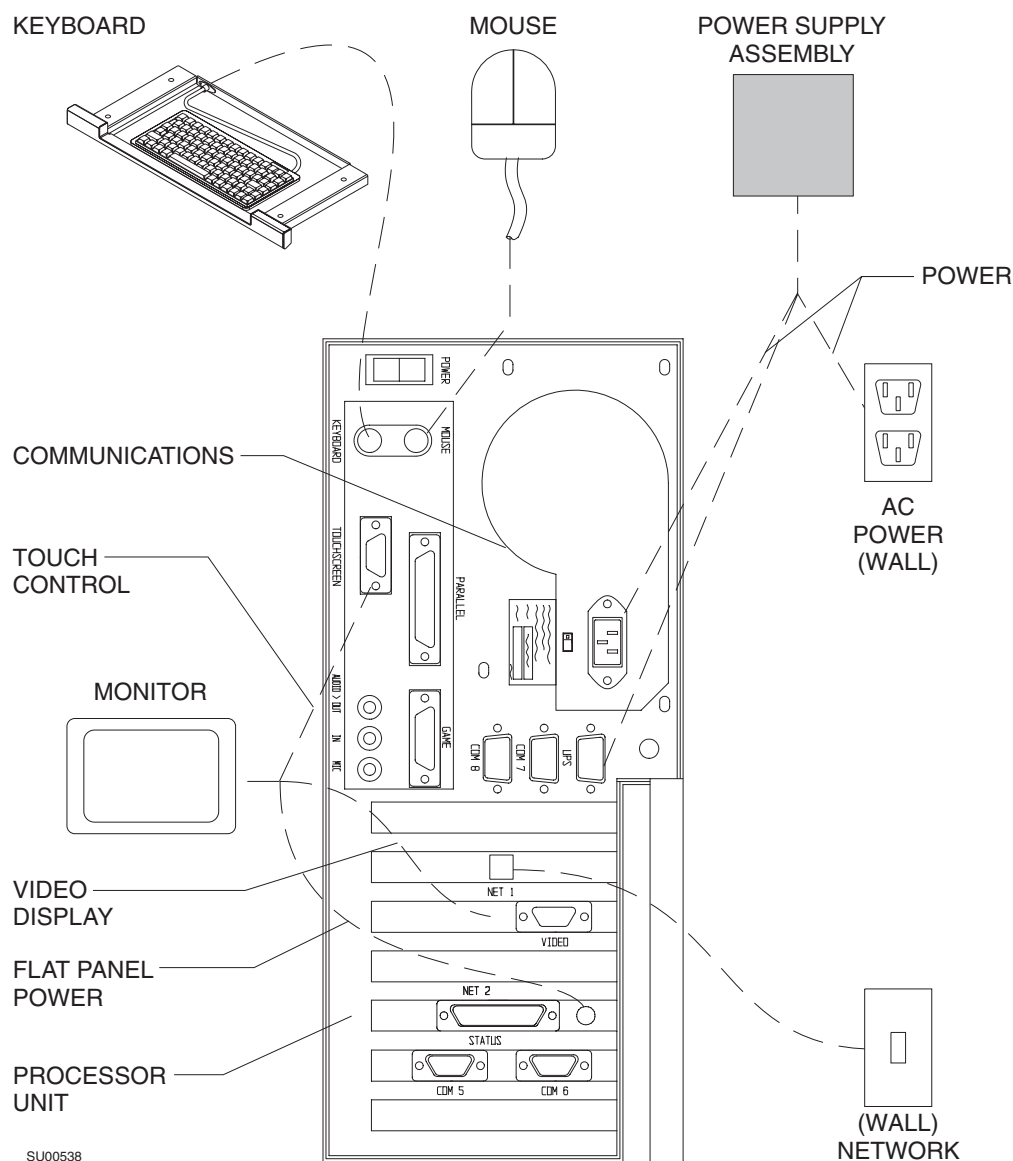

FIGURE 1. Typical 233 Mhz Processor Cable Connections

Replacement Procedure

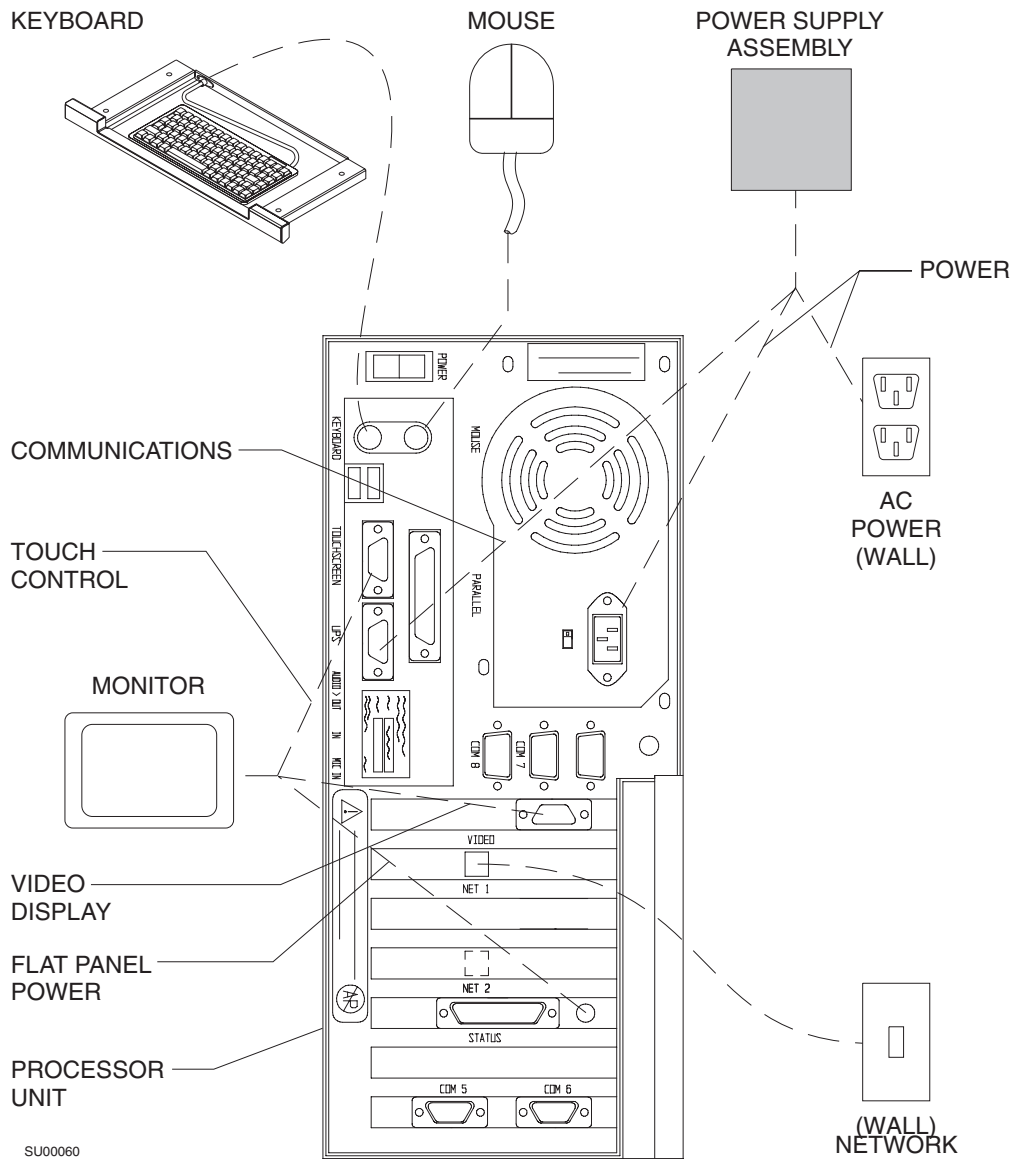

FIGURE 2. Typical 400 Mhz Processor Cable Connections

Replacement Procedure

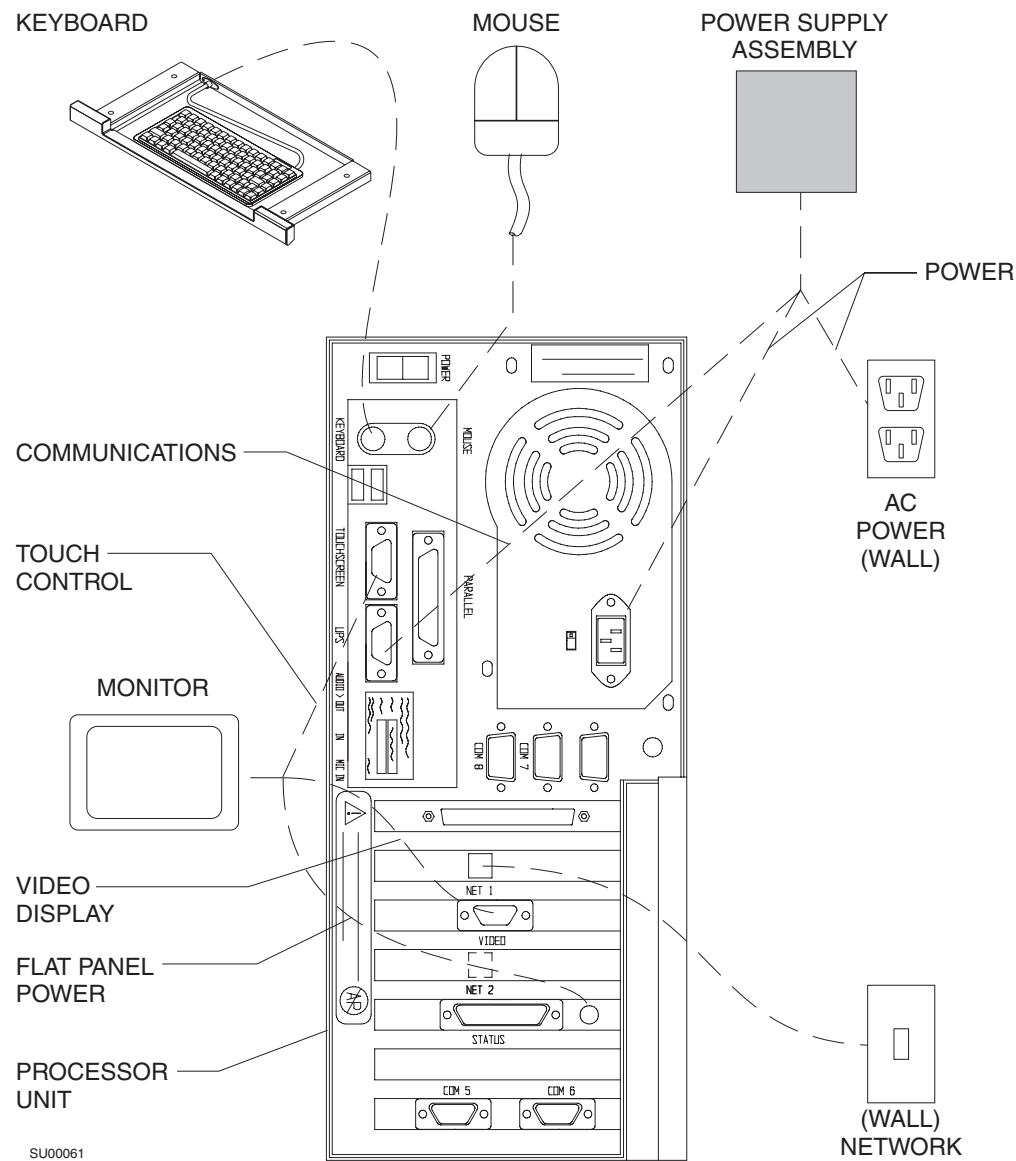

FIGURE 3. Typical 700 MHz Processor Cable Connections

Replacement Procedure

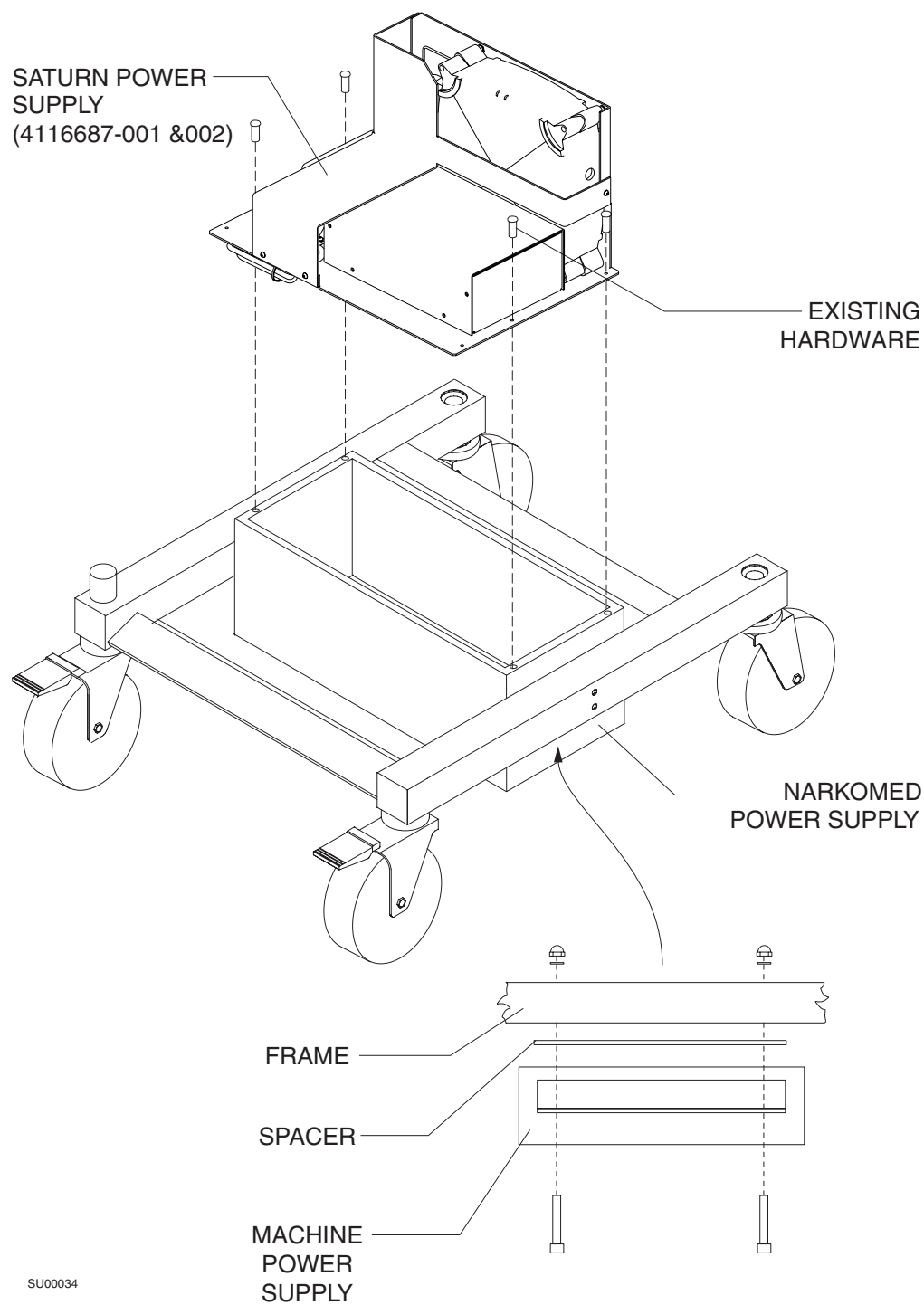

FIGURE 4. Existing Saturn Power Supply Mounting Configurations on Narkomed 4, 3, and 2C

Replacement Procedure

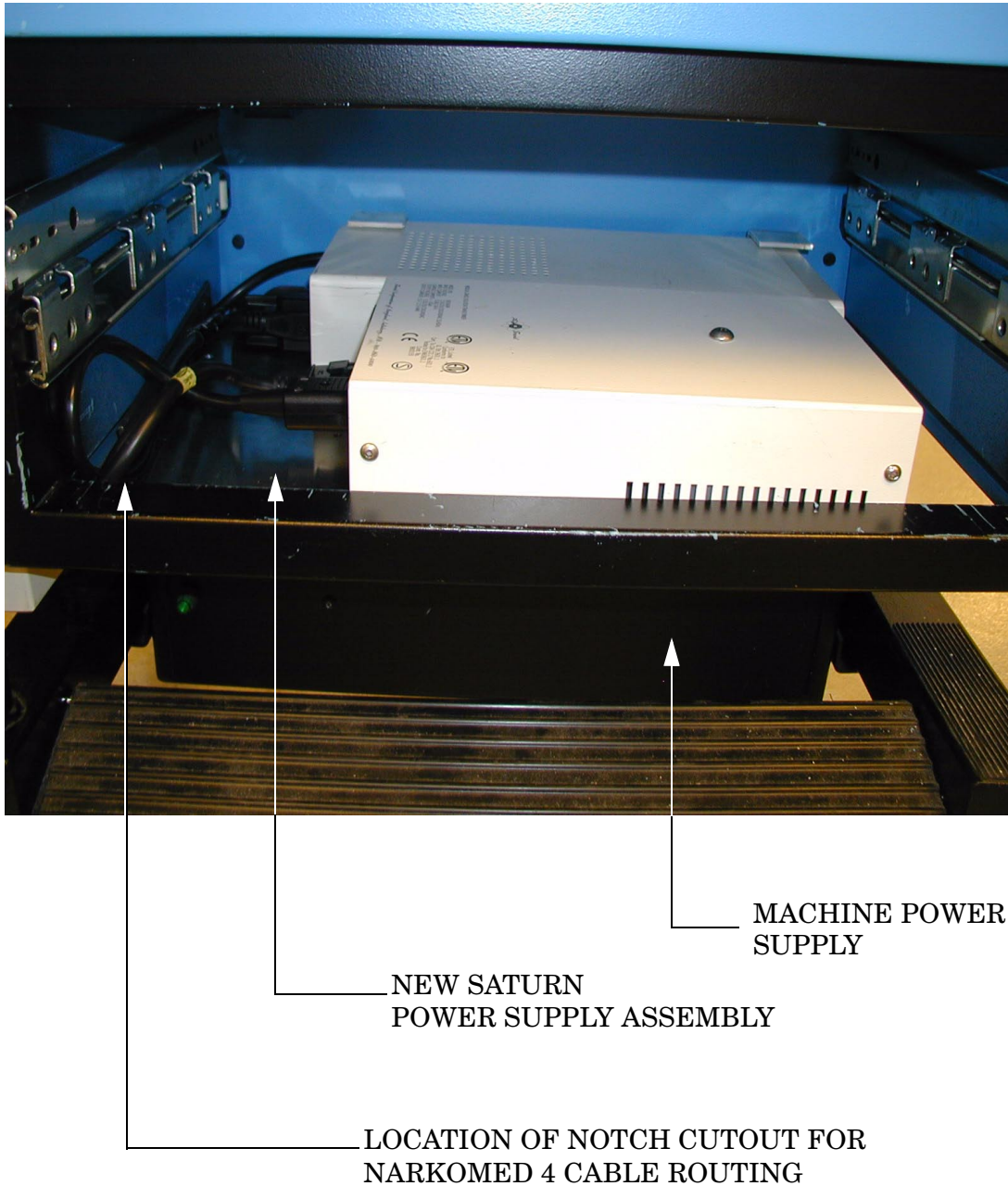

FIGURE 5. Replacement Saturn Power Supply Mounting Configuration on Narkomed 4, 3, and 2C

Replacement Procedure

KIT NUMBER 4117870-002 - NARKOMED 2B AND GS

1. Turn the system power switch to STANDBY.
2. Disconnect AC power from the machine and pull all circuit breakers to their 'out' position.
3. Remove the bottom and middle drawers from the machine by sliding them off of the cabinet rails.
4. Disconnect power supply cables from the Saturn processor. Disconnection of these cables will depend on the processor installed on the machine. Figures 1, 2, and 3 illustrate the cable connections for each of the three processor configurations.
5. Position a support device under the existing Saturn power supply located underneath the Narkomed machine.
6. While supporting the power supply, remove four screws, four flat washers, and four acorn nuts attaching the power supply to the underside of the Narkomed frame. See Figure 6. Discard old power supply and attaching hardware.

NOTE: The Saturn power supply assembly is assembled and shipped from the factory as a unit. This assembly will contain the power supply, the transformer, power supply brackets with attaching hardware, and the label already mounted on the power supply base.

7. Place Saturn power supply assembly flush on the top edge of the bottom frame rails.
8. Align mounting holes on lip of Saturn power supply assembly with the existing holes drilled in frame rail.
9. Using a standard allen wrench, attach the new Saturn power supply assembly using four button head screws and four lock washers. Ensure that A/C outlets are facing the left side of the machine. See Figure 7.
10. Connect new cables from power supply to processor unit. See Figures 1, 2, and 3 for correct cable connections based on the processor installed.
11. Reinstall bottom and middle drawers into machine.
12. Reconnect AC power to the machine and press circuit breakers into their 'in' position.
13. Turn the system power switch to 'ON'.
14. Verify system power up is successful.
15. If system fails to power up, perform the following:

Replacement Procedure

- Ensure circuit breakers are 'in'.
- Ensure AC power is applied to the machine.
- Ensure system power switch is in the 'on' position.
- Ensure cable connections are correct.

16. If system continues to fail power up, contact your DMIT technical service representative.

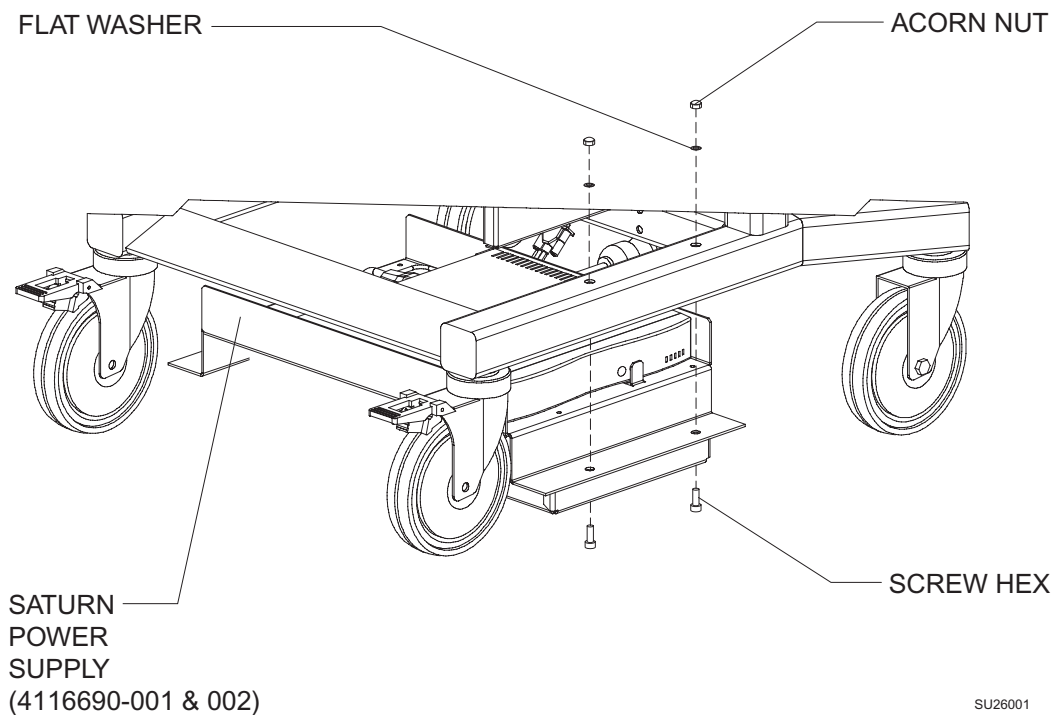

FIGURE 6. Existing Saturn Power Supply Mounting Configurations on the Narkomed 2B and GS

Replacement Procedure



NEW SATURN POWER SUPPLY

NEW SATURN POWER SUPPLY
MOUNTING HARDWARE (TYPICAL FOUR PLACES)

FIGURE 7. Replacement Saturn Power Supply Mounting Configuration on Narkomed 2B and GS

[RETURN TO SERVICE PROCEDURE TABLE OF CONTENTS](#)
[RETURN TO CD-ROM TABLE OF CONTENTS](#)

DrägerService®

Dräger

DrägerService is a division of
Dräger Medical, Inc.
3122 Commerce Drive
Telford, PA 18969
Tel: (215) 721-5402
(800) 543-5047
Fax: (215) 721-5784
Web: www.draegermedical.com
Printed in the U.S.A.