



Advanced B-1000 Pro Electric Bed

Service Manual

SM-B1000PRO
FEB. 2013
REV. 01

In case there is any problem for the bed and need to replace the parts, kindly check below instructions:

1. Replacing the control box:

A) Control box is at the head-side of bed, firstly lift up the backrest bedboard, pull out the plugs of actuator wires and power lines, unscrew the Cross Recess Head Screws which connect the control box to bed frame;



B) Replacing the new control box onto the bed, the procedure is contrary;

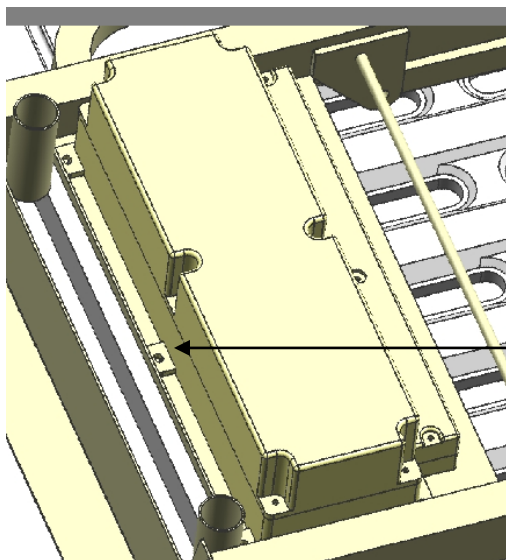

Top of the control box shall be assembled with bed frame by bolts.

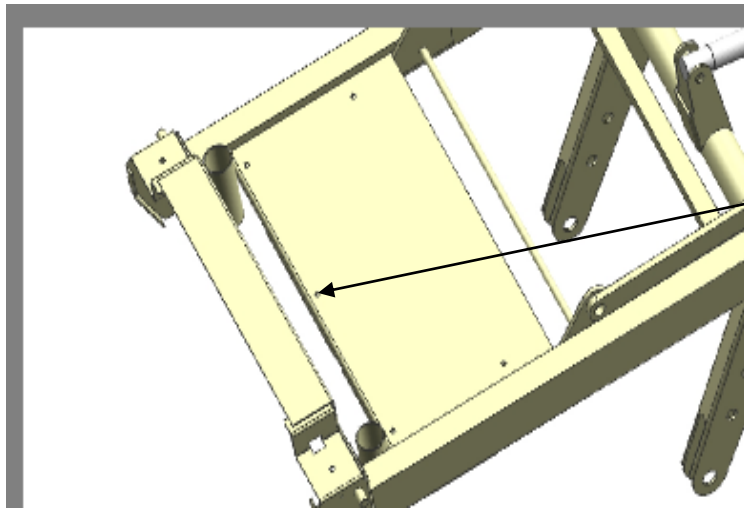

Control box stator shall be fix with bed frame using Cross Recess Head Screw.

2. Replacing the actuators:

- A)** Actuators fixed on bed support bracket with outer hexagon bolts and nuts, unscrew them with tools and replace the right dimension actuators.



B) Totally there are 4 types of actuators on bed, size as below:

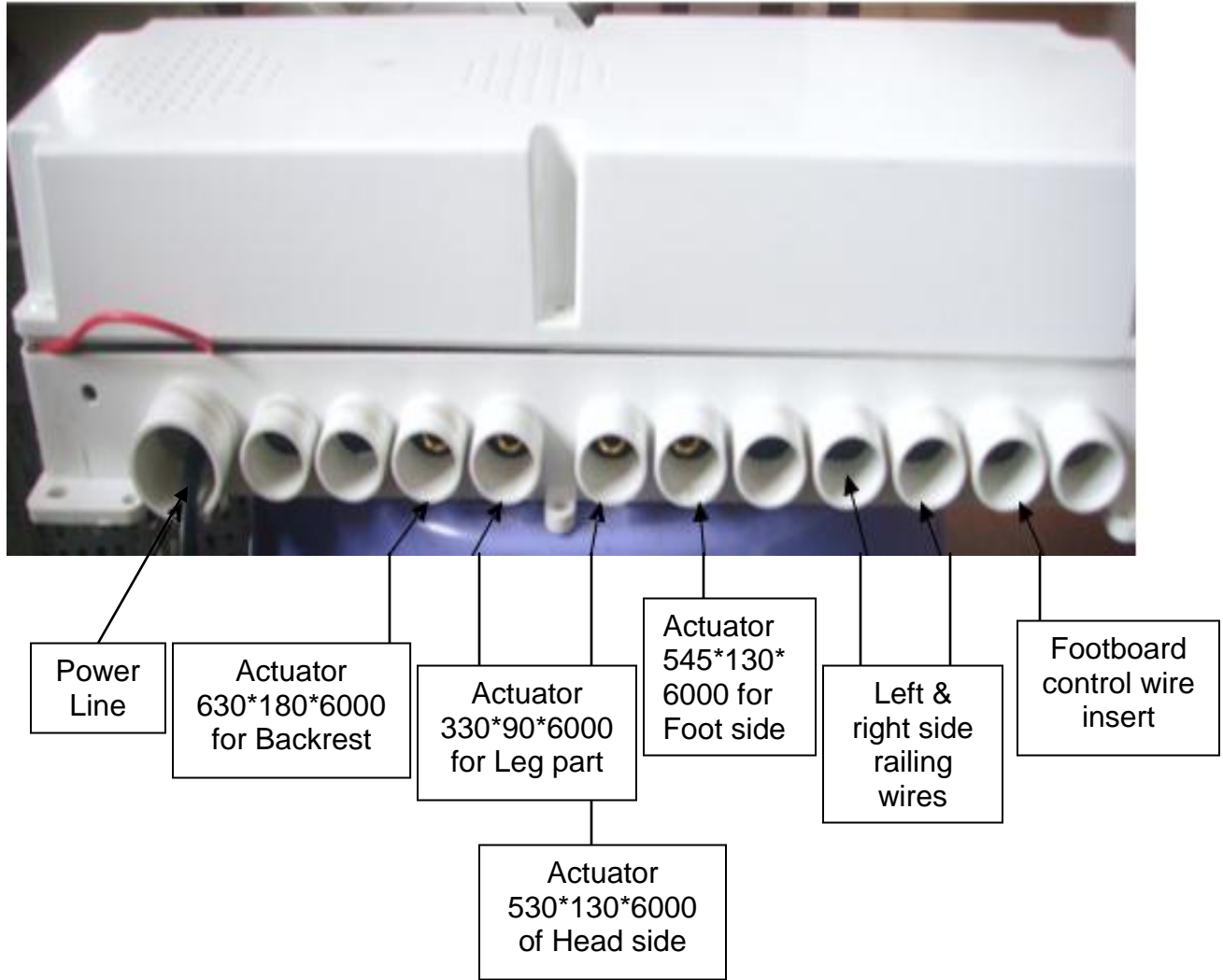

C) How to assemble the bed frame and shift-connection:

This is bed head side shift-connection;
it is active, fix with bolts.

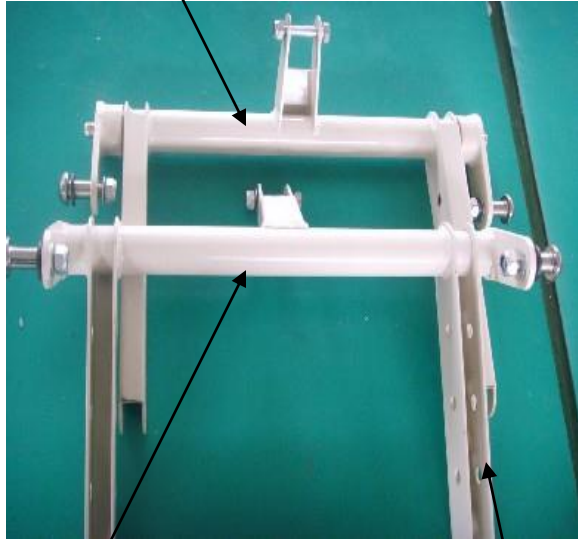

Shift connection contact with bed frame by
M12*44, L 22mm & plastic flat wash.



This is bed foot side
shift-connection.

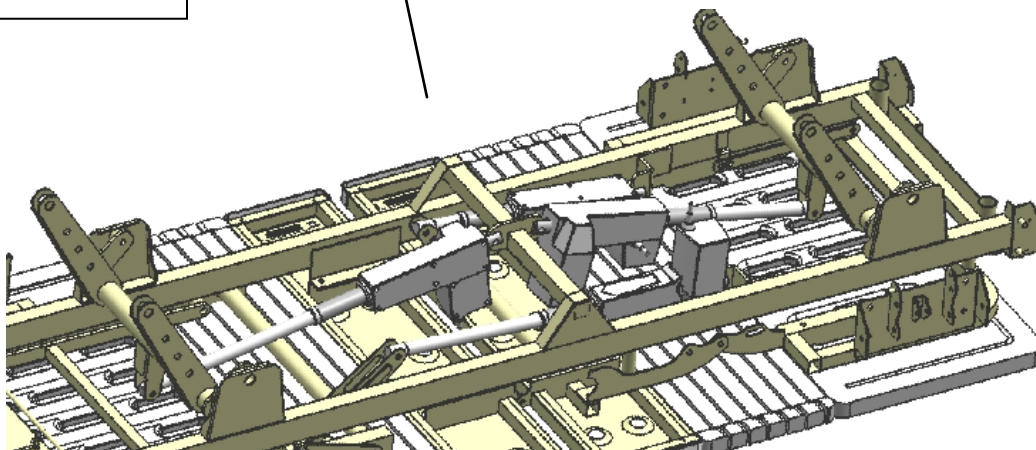

This is the photo of assembled bed frame

D) How to assemble the bed frame and bed chassis:

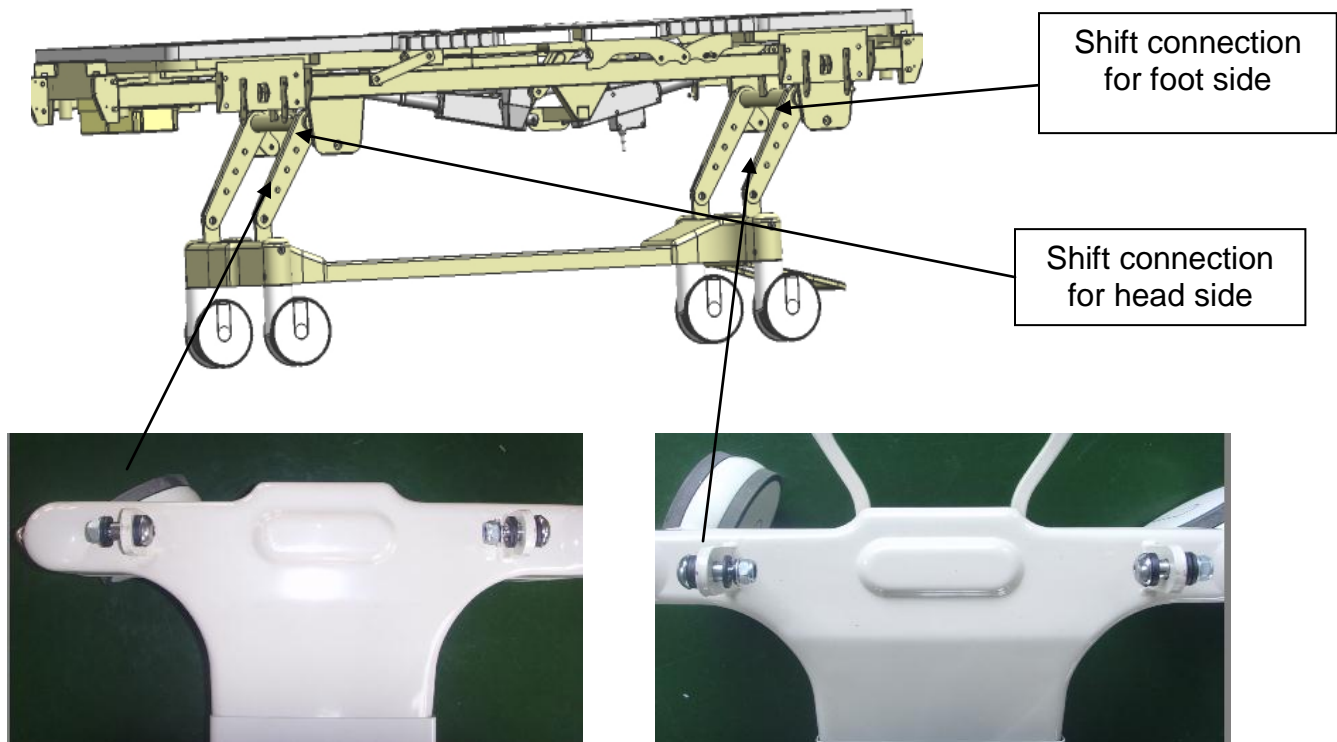

E) How to assemble side railings:

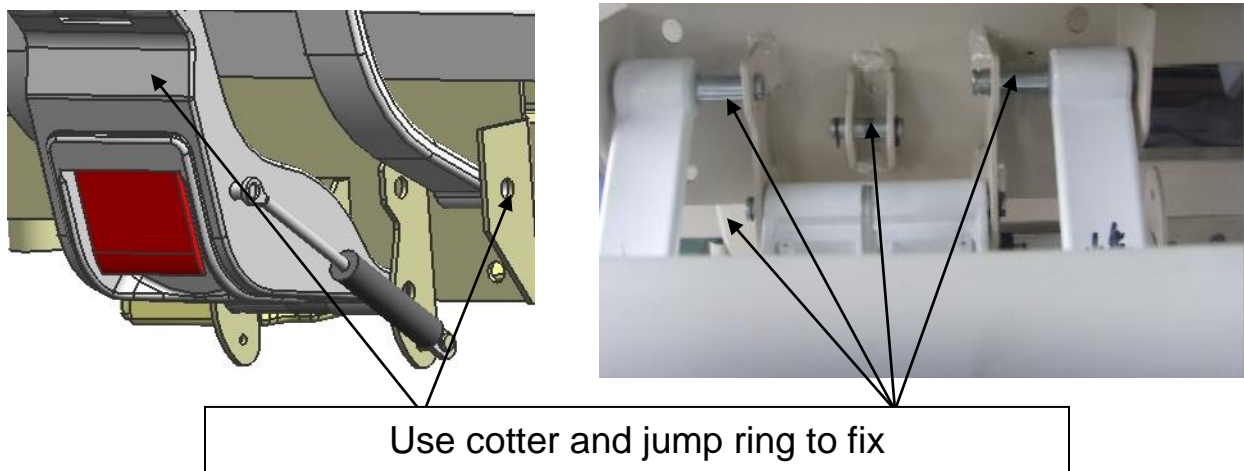

F) Pay attention that there is switch for voltage adjustment, 110V or 220V, DO BE CAREFUL TO SET THE CORRECT VOLTAGE BEFORE USING THE BED.

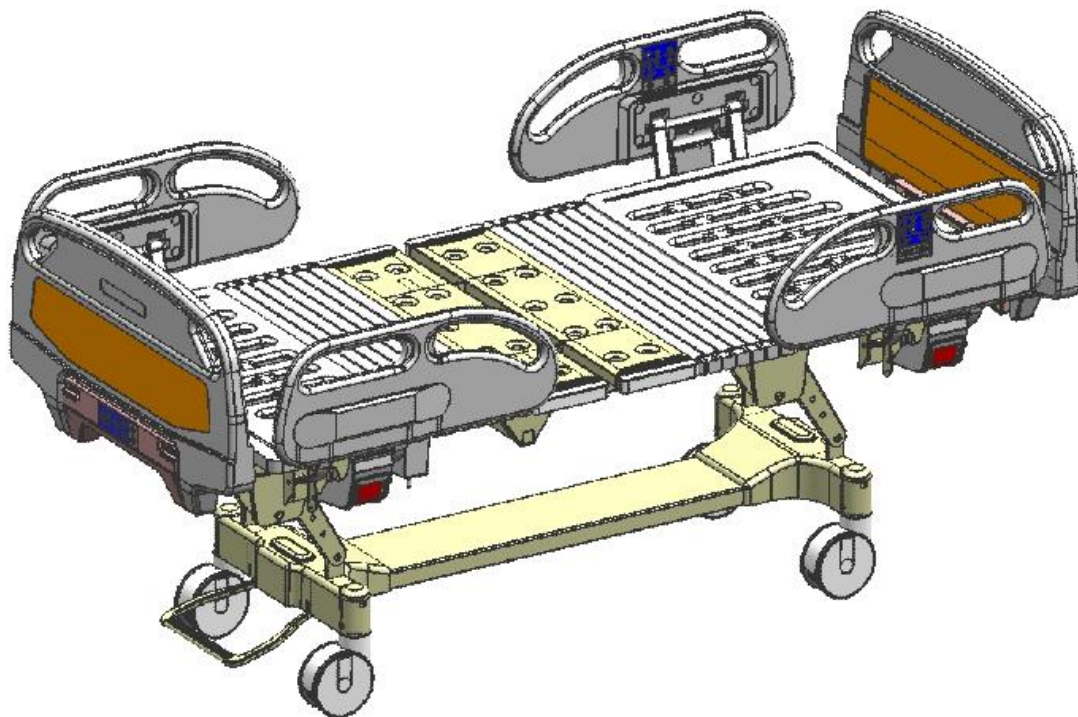
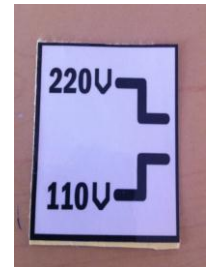



6800 N.W. 77th Ct

Miami, FL 33166

Telephone: 305- 477-6331

Fax: 305-477-5351

Website: www.advanced-inst.com

E-mail: info@advanced-inst.com